

Knurlcraft[™]

Knurling Tools, Cut Type – Single Knurl

No. K1-872

**Straight Pattern Cut Type
Knurling Tool**

With Reversible CNC shanks. Reversible shank for Left or Right hand orientation. User-friendly adjustability of knurl head to fine-tune tooth profile. Integrated set screws for easy adjustment of the clearance angle. Special surface hardening for increased wear resistance. Holders include carbide bushings and two Medium pitch, 30° Diagonal knurl s (BL and BR) to produce a Straight pattern knurl on your part.

Features

- **Machine:** CNC Lathe
- **Capacity:** 300 and 3000mm
- **Knurl Size:** (V) 25x6x8
(Z) 42x13x16
- **Knurl Patterns:** Straight [1 knurl BL or BR 30° as noted below]
- **Knurls Included:** 1 each Medium pitch, 30° Diagonal [BL and BR] knurl to produce a Straight pattern on your part.

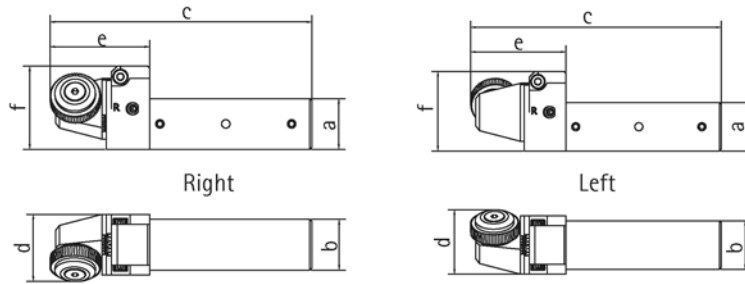

14

Capacity	a	b	c	d	e	f	Knurl Size	Cat. No.
10-300	20	25	129	33	49	36	V-25x6x8	K1-872-M20R-V
10-300	25	25	129	33	49	41	V-25x6x8	K1-872-M20R-V
30-3000	25	25	147	41	67	47	Z-42x13x16	K1-872-M20R-V