

2010

Metric Conversions

MM x 0.03937 = Inches
 Inches x 25.4 = MM
 Grams x 0.03527 = Ounces
 Ounces x 28.349527 = Grams

EAGLE ROCK[®]
 TECHNOLOGIES



Knurling Tools, Form Type – Single Knurl

No. K1-35

Internal Knurling Tools

For knurling internal diameters. Single knurl design accommodates the smallest of bores. Available with both standard and counterbored knurls for blind holes. Each holder includes one Medium pitch, Straight pattern knurl.

Features

- **Machine:** Manual or CNC Lathes
- **Knurl Size:** see below
- **Knurl Patterns:** Straight [1 knurl AA]
 Diamond, Male [1 knurl GV]
 Diamond, Female [1 knurl GE]
- **Knurls Included:** 1 each Medium pitch, Straight pattern [AA]

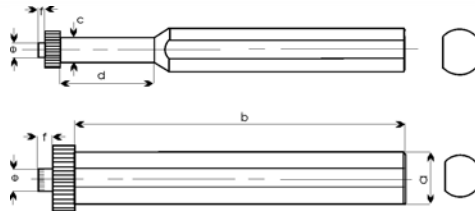

Minimum bore is approx. 10% larger than knurl size diameter.

a	b	c	d	e	f	Knurl Size	Cat. No.
1/2"	6"	0.290	1"	1/4	5/64	A - 5/16 x 5/32 x 1/8	K1-35-0500D-A
1/2	6	—	—	.590"	—	AV - 15 x 6 x 6/8	K1-35-0500D-AV
1/2	6	0.470	1	3/8	3/16	B - 1/2 x 3/16 x 3/16	K1-35-0500D-B
1/2	6	—	—	3/8	3/16	C - 3/8 x 1/4 x 1/4	K1-35-0500D-C
5/8	6	0.290	1	1/4	5/64	A - 5/16 x 5/32 x 1/8	K1-35-0625D-A
5/8	6	0.546	2	.590"	—	AV - 15 x 6 x 6/8	K1-35-0625D-AV
5/8	6	0.470	1	3/8	3/16	B - 1/2 x 3/16 x 3/16	K1-35-0625D-B
5/8	6	0.570	2	3/8	3/16	C - 3/8 x 1/4 x 1/4	K1-35-0625D-C
5/8	6	—	—	.787"	—	L - 20 x 8 x 10/12	K1-35-0625D-L
3/4	6	0.546	2	.590"	—	AV - 15 x 6 x 6/8	K1-35-0750D-AV
3/4	6	0.570	2	3/8	3/16	C - 5/8 x 1/4 x 1/4	K1-35-0750D-C
3/4	6	0.687	2	1/4	5/64	E - 3/4 x 3/8 x 1/4	K1-35-0750D-E
3/4	6	0.710	2	.787"	—	L - 20 x 8 x 10/12	K1-35-0750D-L
1	6	0.546	2	.590"	—	AV - 15 x 6 x 6/8	K1-35-1000D-AV
1	6	0.570	2	3/8	3/16	C - 5/8 x 1/4 x 1/4	K1-35-1000D-C
1	6	0.687	2	1/4	5/64	E - 3/4 x 3/8 x 1/4	K1-35-1000D-E
1	6	0.710	2	.787"	—	L - 20 x 8 x 10/12	K1-35-1000D-L