



Knurling Tools, Form Type – Single Knurl

No. K1-653

CNC Bump Type Knurling Tools

With Modular CNC Shanks. One tool adaptable for a variety of shank sizes. Integrated set screws for easy adjustment of the clearance angle. Special surface hardening for increased wear resistance. Available in either Left or Right hand shanks. Holders include carbide pins and one Medium pitch, Straight [AA] pattern knurl.

- Features**
- **Machine:** Small CNC Lathes
 - **Knurl Size:** (M) 10x4x4
 - **Knurl Patterns:** Straight [1 knurl AA] Diamond, Male [1 knurl GV], Diamond, Female [1 knurl GE]
 - **Knurls Included:** 1 each Medium pitch, Straight pattern [AA]

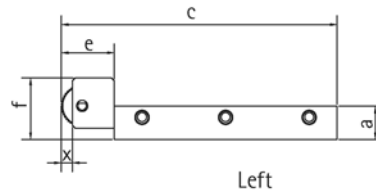
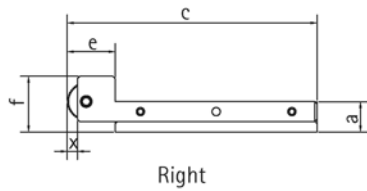

11

Capacity	Shank Size	b	c	d	e	f	x	Knurl Size	Cat. No.
3 - 50mm	8	8	99	12	19	18	4	M-10x4x4*	K1-653-M08L-M
3 - 50	8	8	99	12	19	18	4	M-10x4x4*	K1-653-M08R-M
3 - 50	10	10	99	12	19	20	4	M-10x4x4*	K1-653-M10L-M
3 - 50	10	10	99	12	19	20	4	M-10x4x4*	K1-653-M10R-M
3 - 50	12	12	99	12	19	22	4	M-10x4x4*	K1-653-M12L-M
3 - 50	12	12	99	12	19	22	4	M-10x4x4*	K1-653-M12R-M
3 - 50	16	16	99	12	19	26	4	M-10x4x4*	K1-653-M16L-M
3 - 50	16	16	99	12	19	26	4	M-10x4x4*	K1-653-M16R-M

2010

Metric Conversions

MM x 0.03937 = Inches
 Inches x 25.4 = MM
 Grams x 0.03527 = Ounces
 Ounces x 28.349527 = Grams

EAGLE ROCK[®]
 TECHNOLOGIES



Knurling Tools, Form Type – Single Knurl

No. K1-653

**Bump Type “Up-To-The-Shoulder”
 Knurling Tools**

With Modular CNC Shanks. Uses Counterbored knurls to knurl up to a shoulder. One tool adaptable for a variety of shank sizes. Integrated set screws for easy adjustment of the clearance angle. Special surface hardening for increased wear resistance. Available in either Left or Right hand shanks. Holders include carbide pins and one Medium pitch, Straight [AA] pattern knurl.

- Features**
- **Machine:** Small CNC Lathes
 - **Knurl Size:** (BX) 15x6x6/11
 - **Knurl Patterns:** Straight [1 knurl AA]
 Diamond, Male [1 knurl GV],
 Diamond, Female [1 knurl GE]
 - **Knurls Included:** 1 each Medium pitch, Straight pattern [AA]

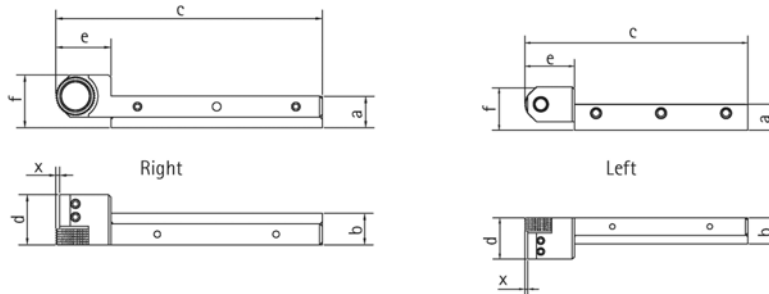

11

Capacity	Shank Size	b	c	d	e	f	x	Knurl Size	Cat. No.
3 - 50 mm	8	8	99	12	19	18	4	BX-15x6x6/11	K1-653-M08L-BX
3 - 50	8	8	99	12	19	18	4	BX-15x6x6/11	K1-653-M08R-BX
3 - 50	10	10	99	12	19	20	4	BX-15x6x6/11	K1-653-M10L-BX
3 - 50	10	10	99	12	19	20	4	BX-15x6x6/11	K1-653-M10R-BX
3 - 50	12	12	99	12	19	22	4	BX-15x6x6/11	K1-653-M12L-BX
3 - 50	12	12	99	12	19	22	4	BX-15x6x6/11	K1-653-M12R-BX
3 - 50	16	16	99	12	19	26	4	BX-15x6x6/11	K1-653-M16L-BX
3 - 50	16	16	99	12	19	26	4	BX-15x6x6/11	K1-653-M16R-BX