

Metric Conversions

MM x 0.03937 = Inches
 Inches x 25.4 = MM
 Grams x 0.03527 = Ounces
 Ounces x 28.349527 = Grams



Wettstein Tool™

Turning Accessories

No. A1-48

PACKER™ 5C Fixture Collets

The **PACKER Fixture Collets** are machinable collet blanks to accommodate an unlimited variety of workholding applications. The 5C shank can be mounted in any 5C collet spindle for turning odd shaped parts or for milling in multi-axis machining centers.

With a little "Toolmaker Ingenuity", multiple cavities can be created to hold and machine multiple parts in a single setup. Mounting in a one or two axis index fixture, the enhanced accessibility of a part can potentially reduce multiple fixturings and cut cycle and setup times.

The threaded 5C back screw is removable and replacable to extend the life-cycle of the collet. When the threads are worn or damaged, the back screw is easily replaced. The fixture collet itself no longer needs to be discarded and remade.

**Patent Pending*

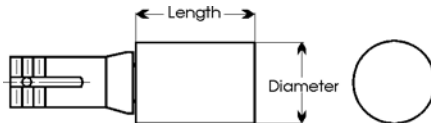

Diameter	Length	Cat. No.
1"	1"	A1-48-5C-1000-1000
1"	2"	A1-48-5C-1000-2000
1"	3"	A1-48-5C-1000-3000
2"	1"	A1-48-5C-2000-1000
2"	2"	A1-48-5C-2000-2000
2"	3"	A1-48-5C-2000-3000
3"	1"	A1-48-5C-3000-1000
3"	2"	A1-48-5C-3000-2000
3"	3"	A1-48-5C-3000-3000
4"	1"	A1-48-5C-4000-1000
4"	2"	A1-48-5C-4000-2000
4"	3"	A1-51-5C-4000-3000
5"	2"	A1-51-5C-5000-2000
6"	2"	A1-51-5C-6000-2000

EAGLE ROCK TECHNOLOGIES INC. *Manufacturers of Specialty Tooling and Accessories since 1963*
 One Eagle Rock Drive
 Bath, Pennsylvania
 18014-9648
 1-610-759-5200 • Fax: 1-610-759-4340
 1-800-EAGLEROCK • 1-800-324-5376
www.EagleRockONLINE.com