

Metric Conversions

MM	x	0.03937	=	Inches
Inches	x	25.4	=	MM
Grams	x	0.03527	=	Ounces
Ounces	x	28.349527	=	Grams

Wettstein Tool[™]

Turning Accessories

No. A1-51
5C Expanding Collets

Tooler's Classics[™]

The most effective and accurate means of internal chucking for short runs to mass production. Features a solid, one piece body for maximum rigidity and repeatability. Once seated in the spindle and machined to size, these collets can hold concentricity well within .0005". Applicable on any machine or fixture with a 5C spindle. Machinable to any configuration within their stock and minimum machinable diameters.

Collets with diameters 4" and larger feature our exclusive lock ring for greater stability and accuracy while machining to their specific application.

4

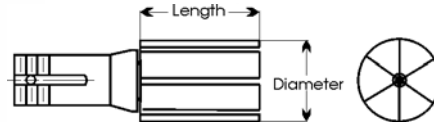

Extended 5C Expanding Collets —
Made for holding delicate or long and narrow parts or where machine clearance is an issue. Machinable to any dimension within their range, only the front [1" long] expands.

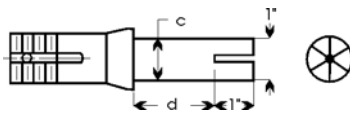

No. A1-51-5C-1000-2000
No. A1-51-5C-1000-3000

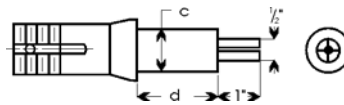

No. A1-51-5C-0500-2000
No. A1-51-5C-0500-3000
No. A1-51-5C-0750-2000
No. A1-51-5C-0750-3000

2010

Metric Conversions

MM x 0.03937 = Inches
 Inches x 25.4 = MM
 Grams x 0.03527 = Ounces
 Ounces x 28.349527 = Grams

EAGLE ROCK[®]
 TECHNOLOGIES

Wettstein Tool[™]

Turning Accessories

No. A1-51 (continued)

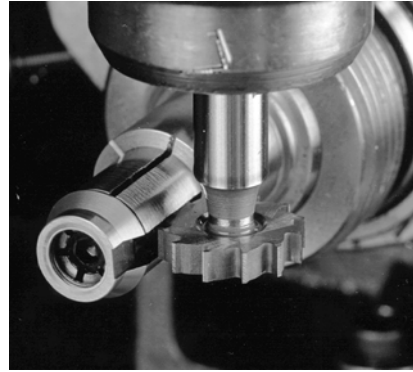
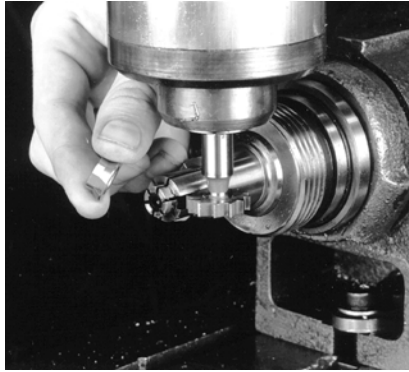

a Dia.	b Lgth.	Minimum Machinable Dia.	c Ext. Dia.	d Ext. Lgth.	Minimum Ext. Dia.	Cat. No.
1/2"	1"	.250"	—	—	—	A1-51-5C-0500-1000
1/2"	2"	.250"	1"	1"	.750"	A1-51-5C-0500-2000
1/2"	3"	.250"	1"	2"	.750"	A1-51-5C-0500-3000
3/4"	1"	.437"	—	—	—	A1-51-5C-0750-1000
3/4"	2"	.437"	1"	1"	.750"	A1-51-5C-0750-2000
3/4"	3"	.437"	1"	2"	.750"	A1-51-5C-0750-3000
1"	1"	.437"	—	—	—	A1-51-5C-1000-1000
1"	2"	.437"	1"	1"	.750"	A1-51-5C-1000-2000
1"	3"	.437"	1"	2"	.750"	A1-51-5C-1000-3000
1 1/2"	1"	.750"	—	—	—	A1-51-5C-1500-1000
1 1/2"	1 1/2"	.750"	—	—	—	A1-51-5C-1500-1500
1 1/2"	2"	.750"	—	—	—	A1-51-5C-1500-2000
1 1/2"	2 1/2"	.750"	—	—	—	A1-51-5C-1500-2500
1 1/2"	3"	.750"	—	—	—	A1-51-5C-1500-3000
2"	1"	.750"	—	—	—	A1-51-5C-2000-1000
2"	1 1/2"	.750"	—	—	—	A1-51-5C-2000-1500
2"	2"	.750"	—	—	—	A1-51-5C-2000-2000
2"	2 1/2"	.750"	—	—	—	A1-51-5C-2000-2500
2"	3"	.750"	—	—	—	A1-51-5C-2000-3000
2 1/2"	1"	.750"	—	—	—	A1-51-5C-2500-1000
2 1/2"	1 1/2"	.750"	—	—	—	A1-51-5C-2500-1500
2 1/2"	2"	.750"	—	—	—	A1-51-5C-2500-2000
2 1/2"	2 1/2"	.750"	—	—	—	A1-51-5C-2500-2500
2 1/2"	3"	.750"	—	—	—	A1-51-5C-2500-3000
3"	1"	.750"	—	—	—	A1-51-5C-3000-1000
3"	1 1/2"	.750"	—	—	—	A1-51-5C-3000-1500
3"	2"	.750"	—	—	—	A1-51-5C-3000-2000
3"	2 1/2"	.750"	—	—	—	A1-51-5C-3000-2500
3"	3"	.750"	—	—	—	A1-51-5C-3000-3000
4"	1"	.750"	—	—	—	A1-51-5C-4000-1000
4"	1 1/2"	.750"	—	—	—	A1-51-5C-4000-1500
4"	2"	.750"	—	—	—	A1-51-5C-4000-2000
4"	2 1/2"	.750"	—	—	—	A1-51-5C-4000-2500
4"	3"	.750"	—	—	—	A1-51-5C-4000-3000
5"	2"	.750"	—	—	—	A1-51-5C-5000-2000
6"	2"	.750"	—	—	—	A1-51-5C-6000-2000

4

Wettstein Tool™

Turning Accessories

No. A1-51

5C Expanding Collet Set

Includes one each of our most popular 5C Expanding Collet sizes in a convenient wooden stand.

Toolcrib Classics™



4

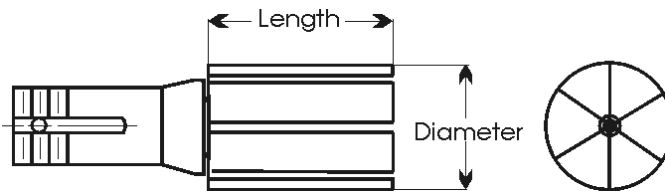

5C Expanding Collet Set

Cat. No.
A1-51-5C-001

Set includes one each of the following collets

Diameter	Minimum Length	Machinable Dia.	Cat. No.
1/2"	1"	.250"	A1-51-5C-0500-1000
1"	1"	.437"	A1-51-5C-1000-1000
1 1/2"	1"	.750"	A1-51-5C-1500-1000
2"	1"	.750"	A1-51-5C-2000-1000